

Commercial Boardwalk Design
 Designed for TRIMAX Structural Lumber
 3'-0" Wide Boardwalk Layout
 100 PSF Live Load
 $\frac{1}{2}'' = 1'-0''$

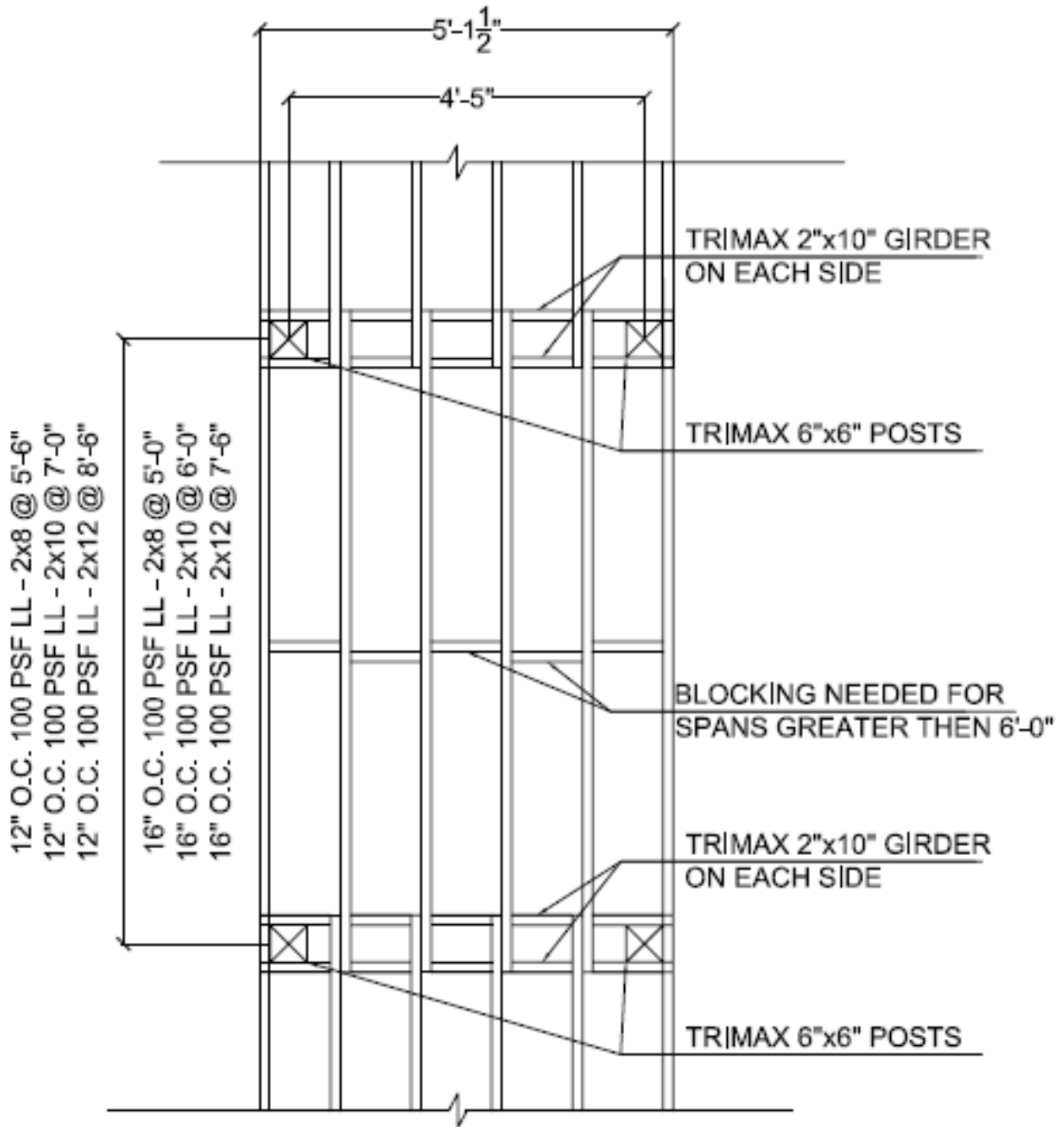

Commercial Boardwalk Design
Designed for TRIMAX Structural Lumber
5'-0" Wide Boardwalk Layout
100 PSF Live Load
1/2" = 1'-0"

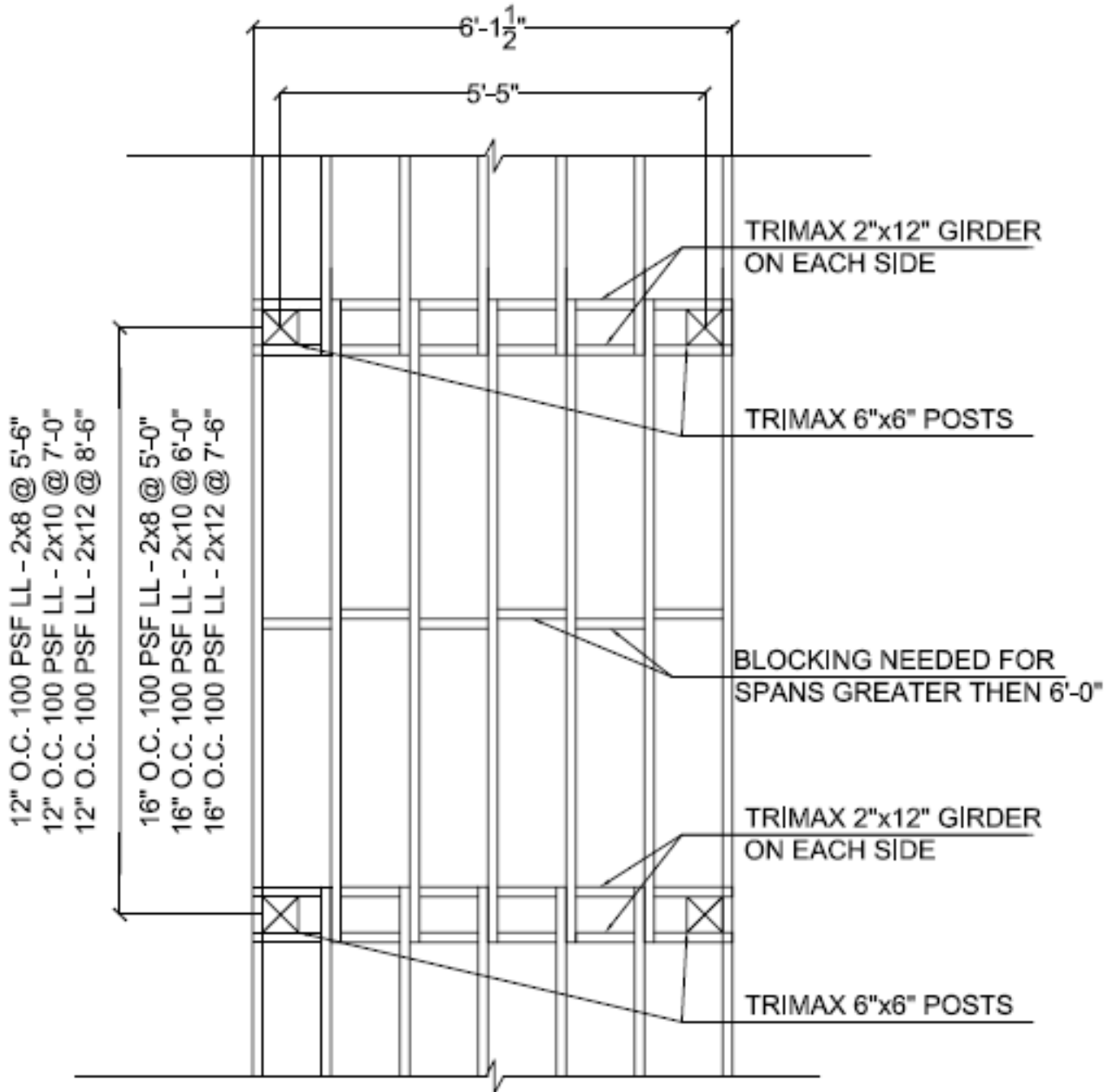

Commercial Boardwalk Design
Designed for TRIMAX Structural Lumber
6'-0" Wide Boardwalk Layout
100 PSF Live Load
 $\frac{1}{2}$ " = 1'-0"

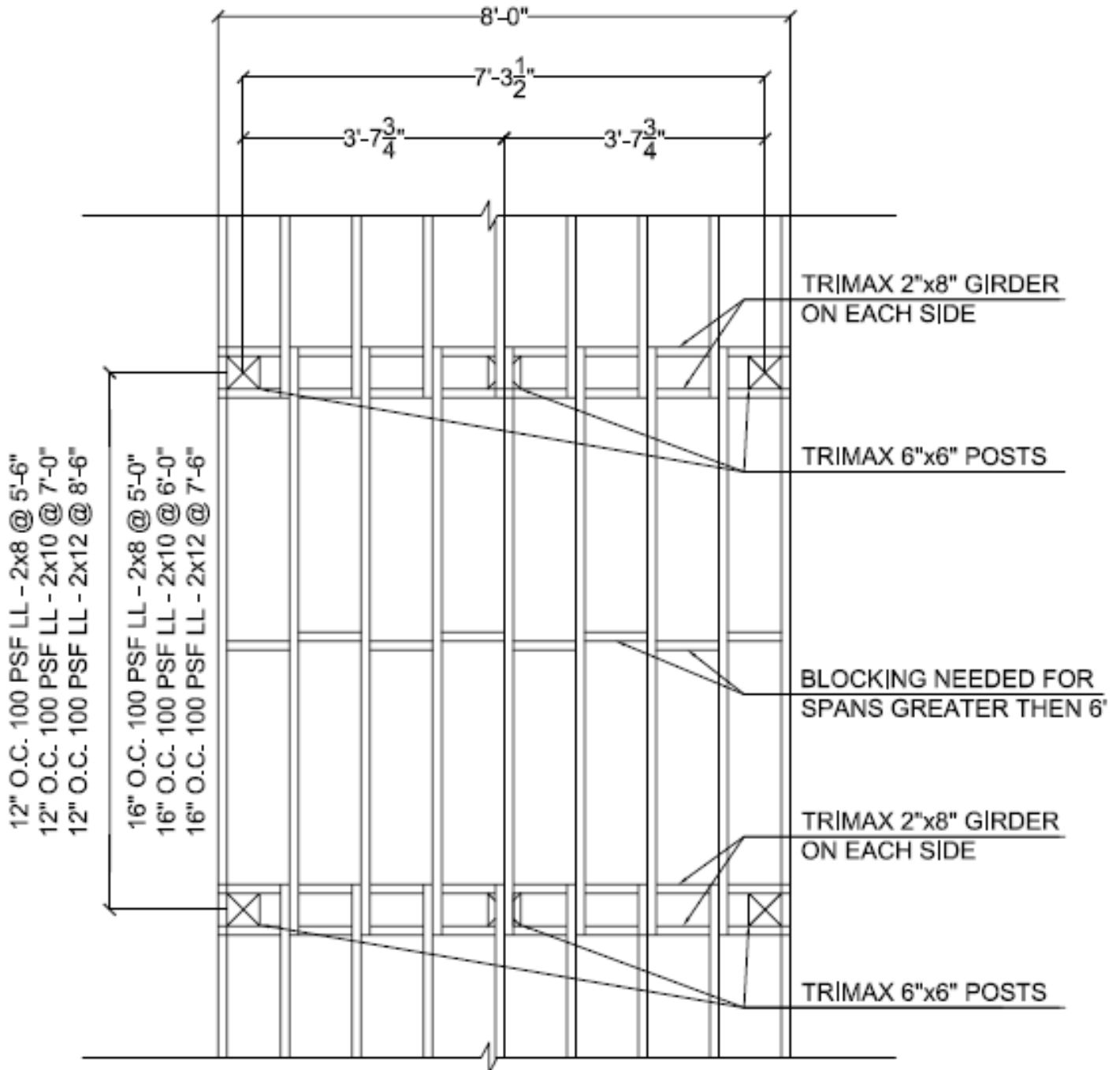

Commercial Boardwalk Design
 Designed for TRIMAX Structural Lumber
 8'-0" Wide Boardwalk Layout
 100 PSF Live Load
 1/2" = 1'-0"